

# COULÉE

SWIRL™

WATER TANK

BREW BUTTON

POWER BUTTON

SWIRL ARM POSTS



SCAN FOR VIDEO  
INSTRUCTIONS

# INSTRUCTIONS FOR USE

1

## ADD WATER

Lift water tank lid and fill to top of island for Golden Cup coffee (fill higher for lighter coffee).

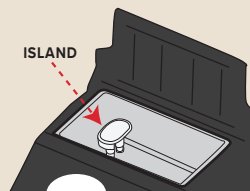

2

## OPEN ECOPOUR™

Remove EcoPour pouch from outer package. Use tab to REMOVE CENTER CAP taking care not to spill coffee.

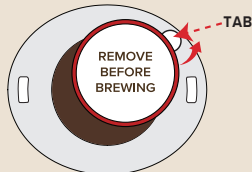

3

## SNAP ECOPOUR ON SWIRL ARM

Align arrows to tabs.

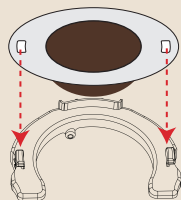

4

## BREW

Power ON Brewer.  
Place mug under the EcoPour.  
Touch brew to start.



## COMPOST!

EcoPour pouches and their outer packaging are 100% compostable!

## TO DISPENSE HOT WATER FOR TEA OR HOT CHOCOLATE

Press the Power Button then Press and Hold the Brew Button for at Least 3 Seconds (until you hear the second, long beep).